

RAK-COMPACT
Wall Hung | Water Closet

RAK
 CERAMICS

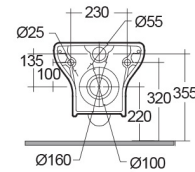
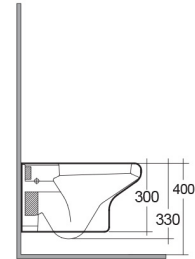
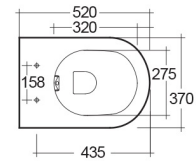

TECHNICAL SPECIFICATIONS

Suite:	RAK-COMPACT
Type:	Wall Hung
Dimensions:	520 x 370 mm
Weight:	19 Kg
Color:	Alpine White
Trap type:	P Trap
Trapway type:	Concealed
Seat cover options:	Urea
Bowl shape:	Round
Flush Type:	Dual Flush
Flush Capacity:	N/A

Code	Name
CO13AWHA	COMPACT WATER CLOSET WALL HUNG 52CM
CO34AWHA	RAK-COMPACT WALL HUNG WATERCLOSET WITH INTEGRATED BIDET SPRAY
JM05DSCQRAWHA	RAK-Jumeriah ABS Soft Close Seat and Cover with Quick Release
JM05DNCQRAWHA	RAK-Jumeriah ABS Normal Close Seat and Cover with Quick Release

YFG173

RAK-Compact Urea Seat Cover

YFG173A

RAK-Compact Urea Soft Close Seat Cover

Dimensions: All dimensions in mm. Tolerance of vitreous china & fireclay items: $\pm 5\%$ for below 200mm and $\pm 3\%$ for above 200mm; for all other items tolerance $\pm 1\%$. Note: Due to a continuing development program to improve design and performance, the manufacturer reserves all rights to vary specifications without prior information. Please note accessories are for photographic use only.