

# RAK-OPULENCE

## Close Coupled | Water Closet

**RAK**  
CERAMICS

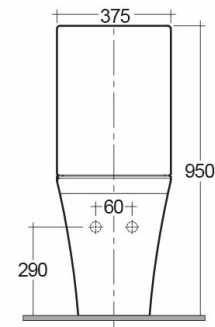
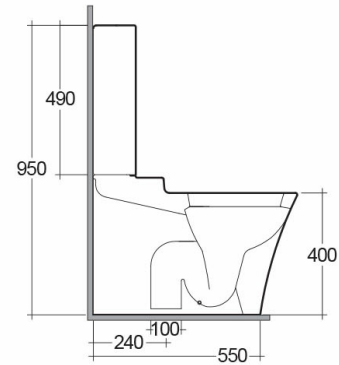
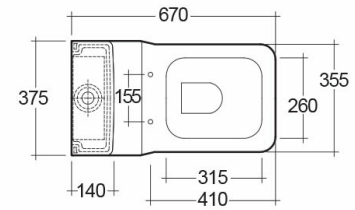

### Technical specifications

|                     |                              |
|---------------------|------------------------------|
| Dimensions:         | 670 x 355 mm                 |
| Weight:             | 48 Kg                        |
| Color:              | Alpine White                 |
| Trap type:          | S Trap                       |
| Trapway type:       | Concealed                    |
| Seat cover options: | Urea                         |
| Bowl shape:         | Rounded Rectangle            |
| Soft close:         | yes                          |
| Flush Type:         | Dual Flush                   |
| Suites:             | <a href="#">RAK-OPULENCE</a> |

| Code        | Name  |
|-------------|---|
| OP03AWHA    | OPULENCE WATER CLOSET CLOSE COUPLED S-TRAP 67CM |
| OP10AWHA    | OPULENCE WATER CLOSET TANK                      |
| YFG101AAWHA | SEAT & COVER (UREA With Soft Close)             |

Dimensions: All dimensions in mm. Tolerance of vitreous china & fireclay items:  $\pm 5\%$  for below 200mm and  $\pm 3\%$  for above 200mm; for all other items tolerance  $\pm 1\%$ . Note: Due to a continuing development program to improve design and performance, the manufacturer reserves all rights to vary specifications without prior information. Please note accessories are for photographic use only.