

RAK-KARLA

Floor Standing | Water Closet

RAK
CERAMICS

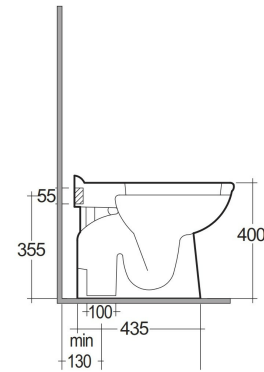
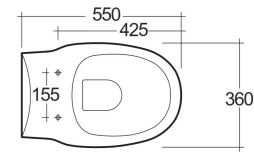

Technical specifications

Dimensions:	550 x 360 mm
Weight:	20 Kg
Color:	Alpine White
Trap type:	S Trap
Trapway type:	Concealed
Seat cover options:	ABS & Urea
Bowl shape:	Oval
Soft close:	yes
Flush Type:	Dual Flush
Suites:	RAK-KARLA

Code	Name
KR20AWHA	KARLA WATER CLOSET BACK OPEN S-TRAP 55CM
KR05DXAWHA	SEAT & COVER (ABS)
KR05DXSCAWHA	SEAT & COVER (ABS SOFT CLOSE)
YFG047AWHA	SEAT & COVER (UREA)

Dimensions: All dimensions in mm. Tolerance of vitreous china & fireclay items: $\pm 5\%$ for below 200mm and $\pm 3\%$ for above 200mm; for all other items tolerance $\pm 1\%$. Note: Due to a continuing development program to improve design and performance, the manufacturer reserves all rights to vary specifications without prior information. Please note accessories are for photographic use only.