

RAK-CLOUD W/HIDDEN FIXATIONS

Back to Wall | Water Closet

RAK
CERAMICS

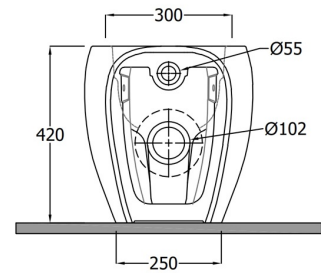
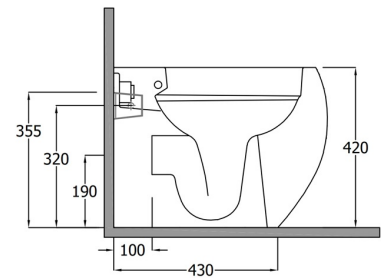
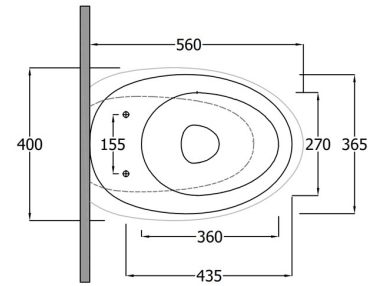

TECHNICAL SPECIFICATIONS

Suite:	RAK-CLOUD
Type:	Back to Wall
Dimensions:	560 x 400 mm
Weight:	30 Kg
Color:	Alpine White
Trap type:	P Trap & S Trap
Trapway type:	Concealed
Seat cover options:	Urea
Bowl shape:	Oval
Soft close:	yes
Quick remove seat cover:	yes
Flush Type:	Dual Flush
Flush Capacity:	Compatible with 6/3L dual flushing, 4,5/3L dual flushing, in accordance with en997-type 1

Code	Name
CLOWC1346AWHA	RAK-CLOUD WATER CLOSET ALPINE WHITE 56CM

CLOSC3901WH

RAK-CLOUD SOFT CLOSE UREA SEAT COVER
(WH)

Dimensions: All dimensions in mm. Tolerance of vitreous china & fireclay items: $\pm 5\%$ for below 200mm and $\pm 3\%$ for above 200mm; for all other items tolerance $\pm 1\%$. Note: Due to a continuing development program to improve design and performance, the manufacturer reserves all rights to vary specifications without prior information. Please note accessories are for photographic use only.